

Park Plaza



 **LED A**



Park Plaza

An outstanding contemporary transitional series, offering bold, sophisticated luxury, flexible in size and shape, and complemented with iridescent primavera veneers and scalloped design details.

The concept emerged from designer David Daniel's all-time favorite French Moderne era, 1930-45 post Deco, with Gilbert Poillera serving as the main inspiration. It's a heritage look, a cross-over between traditional and contemporary, but the essence is cutting edge. Call it Nouveau Deco, if you like. Park Plaza is sexy, approachable, a fully urban aesthetic, and just right for the Affluent Boomer!

Each magnificent piece is hand rubbed in a deep "Port" finish, with a rich yet subtle sheen.

The collection is available for dining room, bedroom and occasional pieces, including home office.

Two dining table options are available: A 50" square table with an extraordinary combination checkerboard reverse diamond top with a scalloped pedestal base and a 54" round table with sunburst top. The floating hutch allows imaginative combinations of single or double presentations with its matching buffet or as another option, with its server.

Two bedroom choices are available with the platform bed and a leather panel bed. And for fun at work, fall in love with the Oval Desk, a superb visual display suitable in either an executive office or home office environment.

This magnificent contemporary collection in a sense is somewhat transitional as it touches the influences of Art Deco offering bold, sophisticated luxury while its clean lines, brushed pewter hardware and scaled proportions provide a strong architectural presence of elegance and high drama.



21-150 SERVER
W 51 D 20 H 39 in.
W 129 D 51 H 99 cm

21-121 ROUND TABLE
Diameter 54 in. H 30 in.
(extends to 72 in. with one 18 in leaf)
Diameter 137 cm H 76 cm
(extends to 183 cm with one 46 cm leaf)

21-131 CROSS BACK SIDE CHAIR
W 22 D 23 H 37 in.
W 56 D 58 H 99 cm.
(shown upholstered in Amerisuede Grain)

21-141 CROSS BACK ARM CHAIR
W 24 D 23 H 37 in.
W 61 D 58 H 99 cm.



21120 50" Square Table
(2 x 25" leaves)

21131 Side Chairs

21150 Server
51w 20d 39h in.

shown in Auburn finish
also available in Port finish
Primavera veneer

Made in Canada



350 Clayson Road
Toronto, ON., Canada M9M 2H2
ph: 416 745 9588 fax: 416 745 1803
info@ledafurniture.com
www.ledafurniture.com

Park Plaza



21-110 FLOATING HUTCH
W 39 D 16 H 47 in.
W 99 D 41 H 119 cm.

21-100 BUFFET
W 78 D 20 H 39 in.
W 198 D 51 H 99 cm.



21-330 BUNCHING CURIO

W 39 D 16 H 85 in.

W 99 D 41 H 216 cm



21-120 SQUARE DINING TABLE

W 50 D 50 H 30 in.

(extends to 100in. with 2 25in. leaves)

W 127 D 127 H 76 cm

(extends to 254cm with 2 64cm leaves)

21-130 SIDE CHAIR

W 21 D 24 H 39 in.

W 54 D 61 H 99 cm

21-140 ARM CHAIR

W 24 D 24 H 39 in.

W 61 D 61 H 99 cm

21-330 BUNCHING CURIO

W 39 D 16 H 85 in.

W 99 D 41 H 216 cm





21-230 NIGHT TABLE
W 36 D 18 H 28 in.
W 91 D 46 H 71 cm.

21-243 QUEEN SIZE PLATFORM BED
W 65 D 91 H 50 in.
W 165 D 231 H 127 cm.
21-242 KING SIZE PLATFORM BED
W 82 D 91 H 50 in.
W 208 D 231 H 127 cm.



21-225 MASTER CHEST
W 68 D 20 H 67 in.
W 173 D 51 H 170 cm.

21-200 DRESSER
W 71 D 20 H 39 in.
W 180 D 51 H 94 cm.

21-210 SILVER LEAF MIRROR
Diameter 43 in.
Diameter 109 cm.



21245 Upholstered Bed
available with a storage platform
or standard footboard and rails

21230 Night Table
36w 18d 28h in.

21401 Round End Table
24w 24d 26h in.

21200 Dresser
71w 20d 39h in.

21210 Mirror
available in shoe-polish black
or silverleaf finish
43" dia.

Primavera veneers
Port or Auburn finish

Made in Canada



350 Clayson Road
Toronto, ON., Canada M9M 2H2
ph: 416 745 9588 fax: 416 745 1803
info@ledafurniture.com
www.ledafurniture.com

Park Plaza



21-220 DOOR CHEST
W 42 D 20 H 74 in.
W 107 D 51 H 188 cm.



21-235 STORAGE CABINET/NIGHT TABLE

W 30 D 18 H 28 in.
W 76 D 46 H 71 cm.



21-400 END TABLE

W 32 D 21 H 26 in.
W 81 D 53 H 66 cm.



21-412 SQUARE COFFEE TABLE

W 48 D 48 H 20 in.
W 122 D 122 H 51 cm.

21-425 SOFA TABLE

W 60 D 19 H 30 in.
W 152 D 48 H 76 cm.



21-410 COCKTAIL TABLE

W 40 D 29 H 20 in.
W 102 D 74 H 51 cm.
Shown in Auburn finish

21-2401 LAMP TABLE

W 24 D 24 H 26 in.
W 61 D 61 H 66 cm.
Shown in Auburn finish



21-403 OVAL COMMODE

W 30 D 22 H 28 in.
W 76 D 56 H 71 cm.



21-311 Workstation Armoire

W 58 D 34 H 60 in.

W 147 D 61 H 152 cm

Retractable twin pocket doors

Double pull-out work surface and keyboard tray

Computer tower storage area and printer pull-out tray

2 box drawers and 1 file drawer

3 interior shelves

Automatic task light



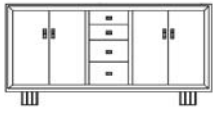

21100 BUFFET
78 x 20 x 39" 198 x 51 x 99cm
cutlery tray drawer
adjustable wood shelf behind doors

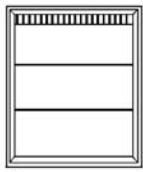

21110 FLOATING HUTCH
39 x 16 x 47" 99 x 41 x 119cm
2 glass doors & mirrored back
2 10mm adjustable glass shelves
multi-setting touch-hinge halogen lighting

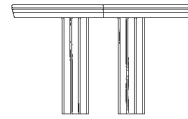

21120 SQUARE DINING TABLE
50 x 50 x 30" 127 x 127 x 76cm
2 - 25" (64cm) leaves
Total opening = 100" (254cm)
checkerboard pattern top and scalloped base

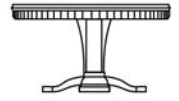

21121 ROUND DINING TABLE
54 x 54 x 30" 137 x 137 x 76cm
plus 1 - 18" (46cm) leaf
Total opening = 72" (183cm)
Sunburst pattern top and scalloped skirt



21130 SIDE CHAIR
21140 ARM CHAIR
24 x 24 x 39"
61 x 61 x 99cm



21131 SIDE CHAIR
21141 ARM CHAIR
24 x 23 x 26"
61 x 58 x 92cm

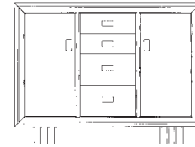

21150 SERVER
51 x 20 x 39" 130 x 51 x 99cm
cutlery tray drawer
adjustable shelf behind doors



21330 CURIO
39 x 16 x 85" 99 x 41 x 216cm
4 glass doors
5 10mm adjustable glass shelves
multi-setting touch-hinge halogen lighting

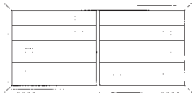

21200 DRESSER
71 x 20 x 39" 198 x 51 x 99cm
jewelry tray insert
8 drawers

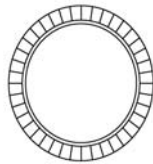

21210 SILVER LEAF MIRROR
43" diameter
109cm diameter
scalloped frame with beveled mirror

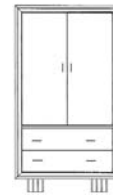

21220 DOOR CHEST
42 x 20 x 74" 107 x 51 x 188cm
2 adjustable wood shelves
pre-wired for television use

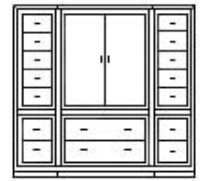

21225 MASTER CHEST
68 x 20 x 67" 173 x 51 x 170cm
adjustable shelves behind center doors
14 side drawers and
2 large center drawers

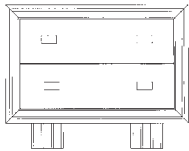

21230 NIGHT TABLE
36 x 18 x 28"
91 x 46 x 71cm

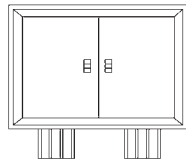

21235 NIGHT TABLE
30 x 18 x 28"
76 x 46 x 71cm
adjustable shelf behind doors

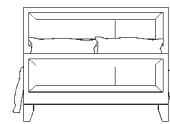

21240 QUEEN LEATHER BED
65 x 84 x 57" 165 x 213 x 145cm
21245 KING LEATHER BED
85 x 84 x 57" 216 x 213 x 145cm

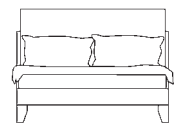

21243 QUEEN PLATFORM BED
65 x 91 x 50" 165 x 235 x 127cm
21242 KING PLATFORM BED
83 x 91 x 50 211 x 235 x 127cm
slat suspension mattress system

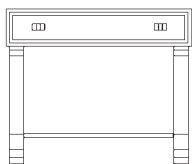

21400 END TABLE
32 x 21 x 26
81 x 53 x 66cm

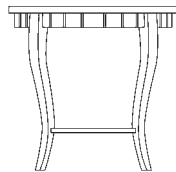

21401 LAMP TABLE
24 x 24 x 26"
61 x 61 x 66cm



21403 OVAL COMMODE
30 x 22 x 28"
76 x 56 x 71cm

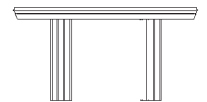

21425 SOFA TABLE
60 x 19 x 30"
152 x 48 x 76cm

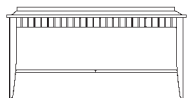

21410 COCKTAIL TABLE
40 x 29 x 20"
102 x 74 x 51cm



21412 SQUARE COFFEE TABLE
48 x 48 x 20"
122 x 122 x 51cm



21840 OVAL DESK
68 x 37 x 30"
173 x 94 x 76cm

Wood Finish:

Leda Furniture maintains strict finishing requirements. Talented craftsmen take extreme pride in the art of finishing, including staining, padding, rubbing and highlighting - all by hand. We are very careful to formulate and apply each finish to exacting standards. However color variations will occur because natural woods vary in their reaction to finishing materials due to age, grain pattern and raw wood tone. The finish shown is reproduced as accurately as printing techniques permit.

Caring for Park Plaza

Wood Finish:

Leda finishes are resistant to most everyday hazards, however some precautions are necessary to maintain the beauty of your furniture.

- regular dusting with a soft clean cloth, slightly moistened with water. Dry completely with a separate dry cloth, always rubbing with the grain pattern.
- avoid contact with harsh solvents, ie. hot dishes, nail polish, alcohol and moisture.
- clean spills immediately.
- use pads when displaying accessories and heated items on table and cabinet
- do not place furniture tops near heating outlets, windows or direct sunlight.

Decorative Hardware:

- clean with a soft damp cloth.
- avoid using harsh detergents or polish on the hardware.

These practices will help your Leda Furniture maintain its beauty and elegance for years to come.

Statement of Quality

Leda has manufactured furniture since the late 1960's, utilizing state of the art technology, skills and craftsmanship. Each piece is made to exacting standards and of the highest quality materials available. All pieces are inspected at numerous intervals during the manufacturing process, including a final inspection prior to packaging.

Despite our best efforts some imperfections may occur once the furniture has had time to settle after the manufacturing process. These situations may require repairs and/or part replacements

Leda Furniture selects glass and mirrors of the highest quality to complement the furniture. However the very best glass and mirrors may have certain characteristics that are inherent in the glass making process, these include faint scratches, air bubbles and pitted areas. These minor allowable marks do not detract from the beauty and integrity of the product.

Leda Furniture Ltd stands behind its product in regard to manufacturing related issues (materials, workmanship) for a period of one year from date of shipment from our factory.

Note to Retailers:

All furniture photographed are available to qualified Leda Furniture retailers. Possession of this catalog does not necessarily constitute authority to purchase, nor does the furnishing of this catalog constitute an offer by Leda to sell any or all of the items contained herein.

All photography, illustrations and specifications in this catalog represent the most current product information available at time of printing. All information, product design and product availability is subject to change without notice.



LEDA FURNITURE LTD.

350 Clayson Road, Toronto, Ontario, Canada. M9M 2H2

Tel: (416) 745-9588 Fax: (416) 745-1803

email: info@ledafurniture.com www.ledafurniture.com